

# Instruction Manual

Wireless CarPlay/Android Auto Integration  
for Audi MIB/MIB II system

Model No.	VI-AD320C-B9
MCU Ver.	19.1.11.12
SW Ver.	V2.0.1.4.lzy
Manual Ver.	1.0
Date	May 17. 2019



## Content:

● Warning	3
● Compatibility	5
● Features	6
● Package Components	7
● Connection Diagram	8
● How to connect an external MIC (optional)	9
● DIP Setting	10
● Operation Instruction	11
■ How to switch from original to add-on interface	11
■ Add on module UI	12
■ How to connect/disconnect wireless Apple CarPlay	13
■ CarPlay operation	14
■ Android Auto operation	15
■ Other settings	16



## Warning:

- In order to protect the driving safety and avoid break the traffic law; please DO NOT operate the interface while driving.
- The reversing surveillance function just is used in reversing assistance. Please check the entire surroundings while reversing.
- All steps of installation should be done by the well-trained specialist.
- During installation, the ignition key should be taken off and after all installation finished, connect power cable last.
- Please DO NOT plug or pull the connected cables in the state of power-on, in order to avoid damaged monitor or accessory.
- Install wiring in a manner in which cables will not come in contact with metal parts. The wiring may be damaged by contact with metal parts, resulting in fire and shocks. Avoid all contact with hot surfaces when wiring the main unit. High temperatures may damage wiring, causing shorts, arcing and fires.
- Please DO NOT put the product in the damp environment or water, in order to avoid electric shock, damaged and fire accident caused by a short circuit.
- Kindly check all components are in the box when receiving the product. If anything missing, inform to the supplier/manufacturer.
- Start the engine before loading, check the interface whether have function displayed, key control whether correct, the vehicle



---

interface whether having a scratch. Please give the feedback to the supplier/manufacture if there have any questions.

- Please note that put the disassembled automotive components in a good way on the installation process, avoid scratching the instrument panel, the leftovers of connecting cables need to handle and DO NOT leave it in the car. The connecting plug must be insulated in order to short circuit.
- The cables should be connected in a good way; the vehicle installation space is a little small, so reduce space usage as far as possible. There should be a good plan about connect cables, avoid affecting the active component of connecting, such as control components of turning the steering wheel, throttle and brake pedal. There need to be fastened after connecting cables in case of a drop.



## Compatibility:

Brands	Model	Years	Original System
Audi	A3	2013-	Select vehicles with <b>MIB/MIB2 STD</b> , <b>5.8 / 7 inch</b> monitor <b>4 Pin LVDS</b> connector
	A4/S4	2016-	
	A5/S5	2016-	
	Q5	2018-	
	Q7	2016-2018	



**NOTE!** This interface does NOT fit vehicles with 8.3 inch factory screen.



## Features:

- Support wireless & wired Apple CarPlay, wireless & wired Android Auto, AirPlay mirroring
- USB HD video and lossless music playback (APE, WAV, FLAC, MP3, WMA, etc.)
- Offer 2 CVBS video input (front & rear view camera)
- Support PDC (Parking Distance Control) and FPG (Flexible Parking Guidelines)
- Display front view automatically after shifting from R gear, also support setting the duration
- Integrated DSP module offers high quality audio effect
- Operate by OEM knob controller & steering wheel buttons
- Support OEM microphone
- Further software update via USB port



Wireless/  
wired  
CarPlay



Wireless/wired  
Android Auto



AirPlay  
Mirroring



USB media  
playback



F/R view  
cameras



FPG



PDC



Further SW.  
update



## Package Components:



**Main Unit**  
Dimension: 130\*105\*30 mm



**Quadlock Main Power Cable**



**4 pin LVDS Cable**



**USB & CVBS Cable**

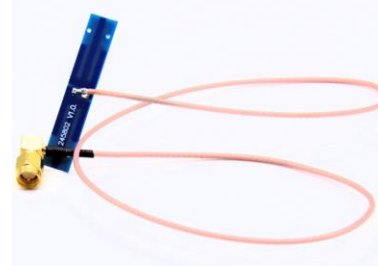

**WiFi & BT Antenna**

### Optional Component:



**External Microphone**  
(Needed when a car **without**  
**OEM MIC**)

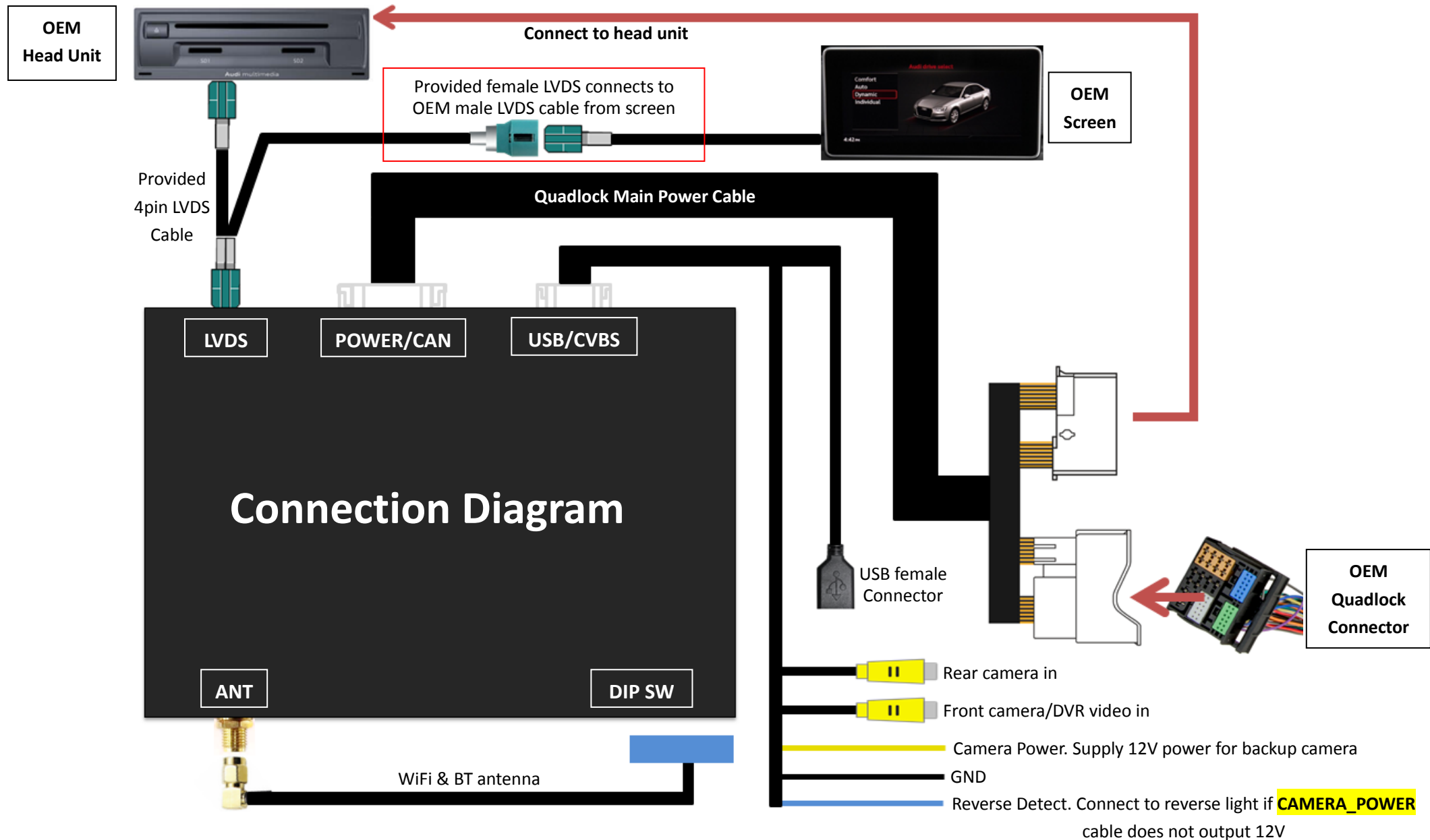



## How to connect an external MIC (optional):

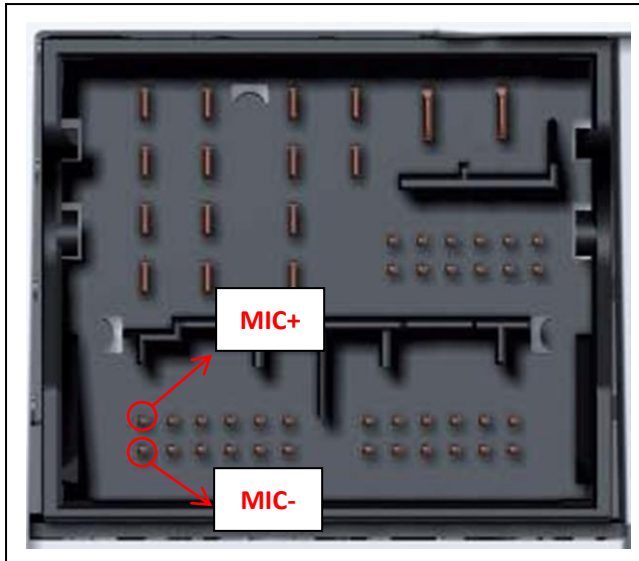

Connect the external microphone to pinout **MIC+** and **MIC-** of OEM quadlock connector.

**NOTE!** Ignore this page if your car integrates original microphone.

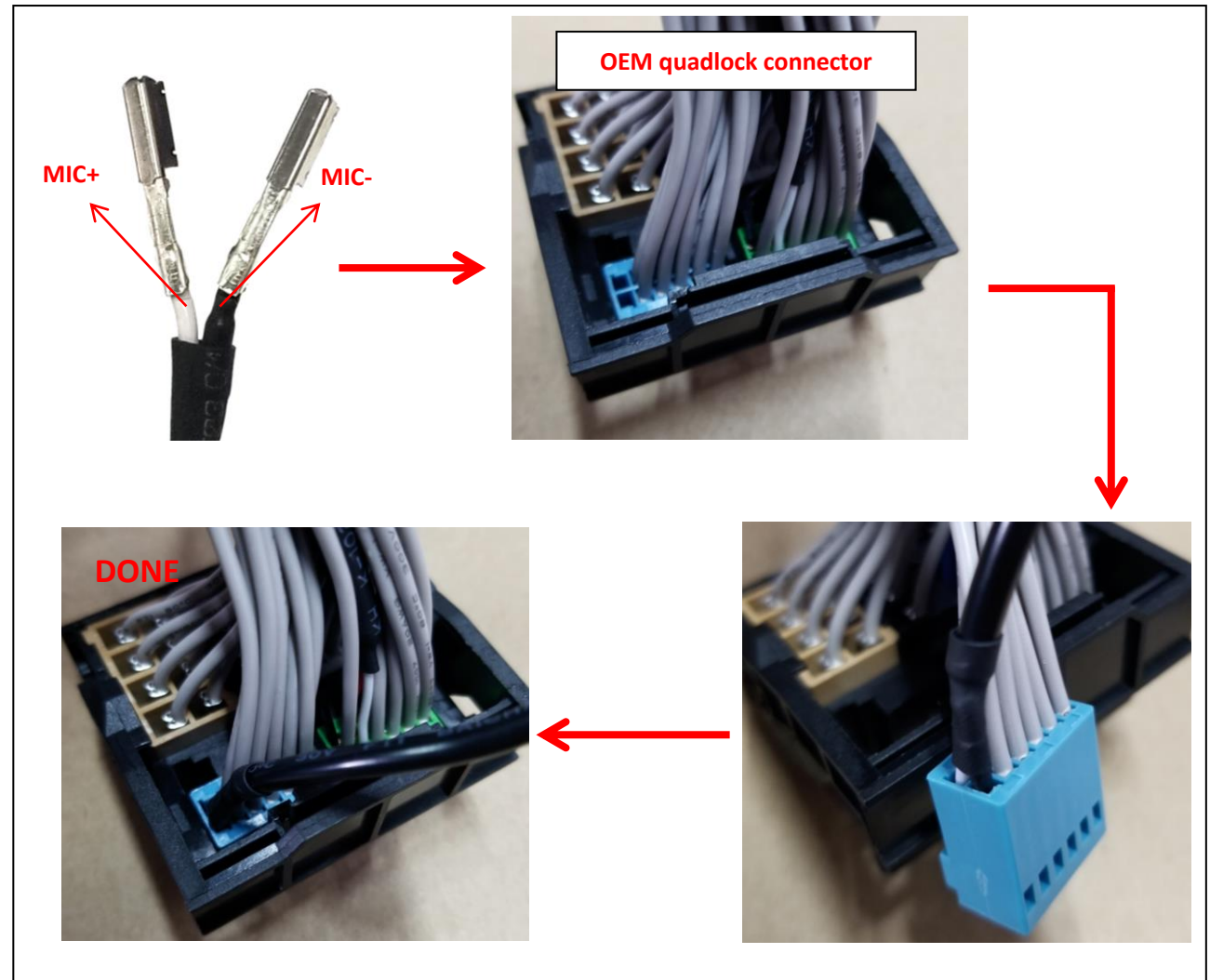

## DIP Setting:

DIP						Selection of car model	Model
1	2	3	4	5	6		
ON	ON	OFF	OFF	ON	ON	2013-2016 A3 (5.8 inch)	AD320C-B9
ON	ON	OFF	ON	ON	OFF	2017- A3 (5.8 inch)	
ON	ON	ON	OFF	OFF	ON	2013-2016 A3 (7 inch)	
ON	ON	ON	OFF	OFF	OFF	2017- A3 (7 inch)	
ON	ON	OFF	ON	OFF	OFF	2016- A4/S4/A5/S5 (7 inch); 2018- Q5 (7 inch)	
ON	ON	ON	OFF	ON	ON	2016-2018 Q7 (7 inch)	
OFF	OFF	OFF	OFF	OFF	OFF	2013-2017 Q5 (MMI); 2012-2015 A4/A5/A6/A7 (MMI)	AD320C-Q5U; (AD320C-A6 for 2012-15 A6/A7)
OFF	OFF	OFF	ON	ON	ON	2010-2012 Q5 (MMI); 2010-2011 A4/A5 (MMI)	
OFF	OFF	ON	ON	OFF	ON	2010-2011 A6 (C6)	AD320C-Q7
OFF	OFF	OFF	OFF	ON	OFF	2010-2015 Q7	
OFF	OFF	ON	ON	ON	ON	2016-2018 A6/A7	AD320C-A7C
OFF	OFF	ON	ON	OFF	OFF	2014-2018 Q3	AD320C-Q3S
OFF	OFF	OFF	OFF	OFF	ON	A8	AD320C-A8
OFF	OFF	OFF	ON	OFF	ON	Without MMI: 2009-2015 A4/A5/Q5	AD320C-SYM

DIP	ON	OFF
7	Car without "PARK" button	Car with "PARK" button
8	External microphone	OEM microphone

Factory test DIP setting (No.1~6):

**OFF – OFF – ON – OFF – ON – OFF**

**NOTE!** Please reboot the interface for effective after changing any DIP setting.



# Operation Instruction:

- How to switch from Original to Add-on interface

Long press "MEDIA"



Order: OEM - Add on - OEM



OEM UI



Add on Module Interface

How to delivering  
audio to OEM  
radio

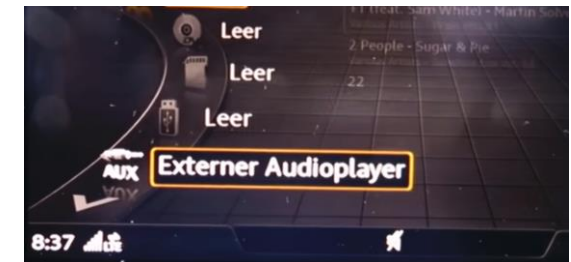

**NOTE!** Make sure switch to "AUX" mode on original car stereo for audio transmission before using the CarPlay integration.



**NOTE!** If a car without AUX jack but with AMI, please plug in an AMI cable to factory AMI port, and do not connect anything with another side of the cable.



## ● Add on module UI

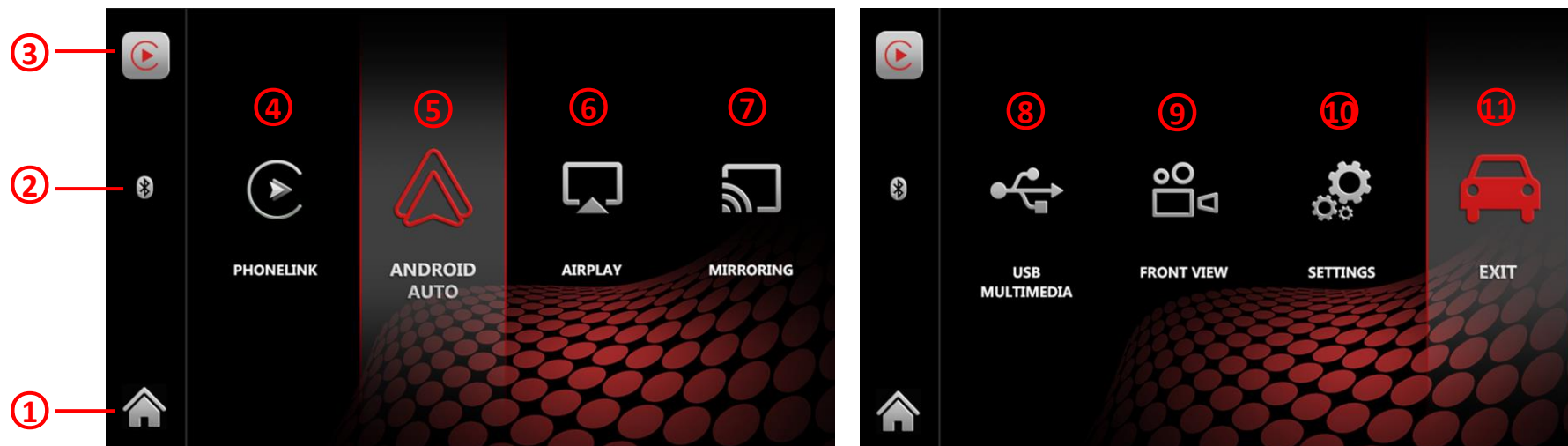

- |   |   |
|---|---|
| ① Home of add on module UI  | ⑥ Wireless AirPlay mirroring for iPhone   |
| ② Display when a mobile phone has connected to integration's Bluetooth                                  | ⑦ USB cable screen mirroring for iPhone   |
| ③ CarPlay/Android Auto status bar. Display when iPhone/Android phone has connected CarPlay/Android Auto | ⑧ USB multimedia (music & video) playback |
| ④ Wireless/Wired CarPlay and wireless Android Auto  | ⑨ Front view/DVR video in                 |
| ⑤ Wired Android Auto  | ⑩ Settings                                |
|   | ⑪ Back to factory infotainment            |



## • How to connect wireless Apple CarPlay



Select **PHONELINK** and make sure your iPhone enables WiFi & Bluetooth and stay on BT setting menu

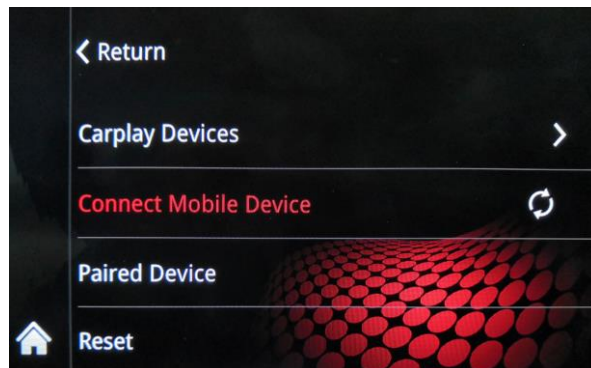
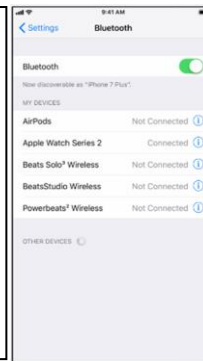

Connect Mobile Device

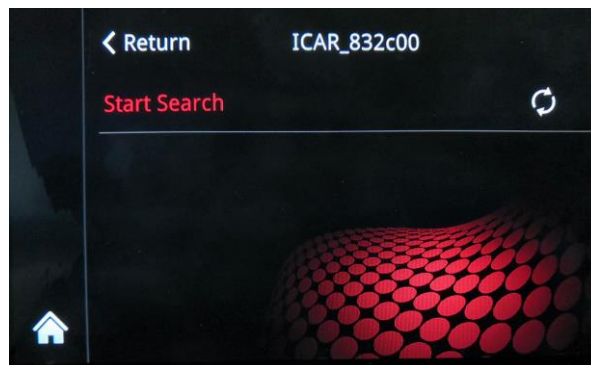

Start Search

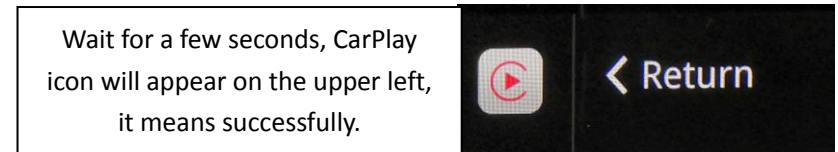

Wait for a few seconds, CarPlay icon will appear on the upper left, it means successfully.

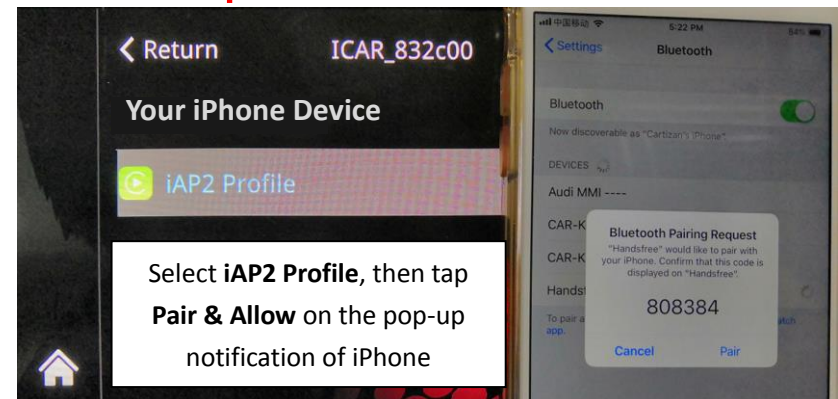

Select **iAP2 Profile**, then tap **Pair & Allow** on the pop-up notification of iPhone

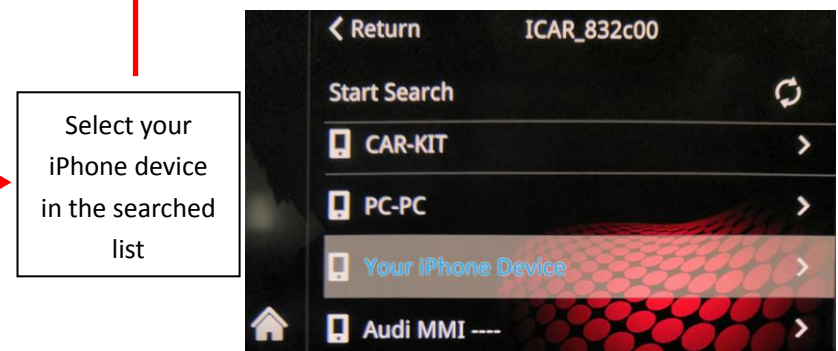

Select your iPhone device in the searched list





## • How to disconnect wireless Apple CarPlay

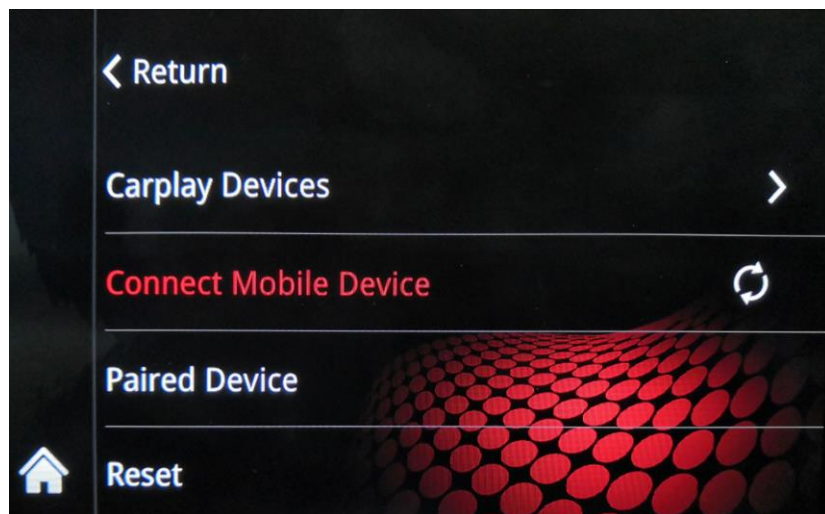

Connected CarPlay devices, you can disconnect CarPlay in the next menu: select your device, and then tap it to disconnect CarPlay.

Bluetooth paired devices, you can find out all BT paired devices list here

Reset add on module

## • CarPlay Operation

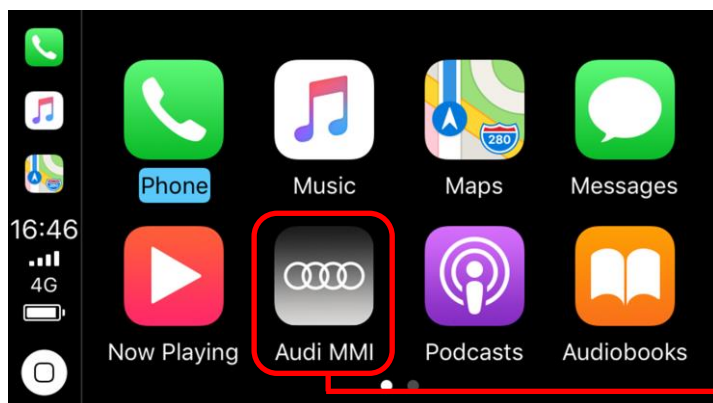

Back to add on module



Long press 3S to activate  
**Siri**



## • Android Auto Operation

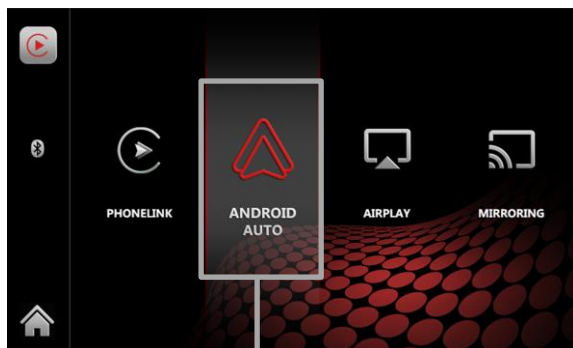

Plug in Android smartphone with USB cable, tap **ANDROID AUTO** to start

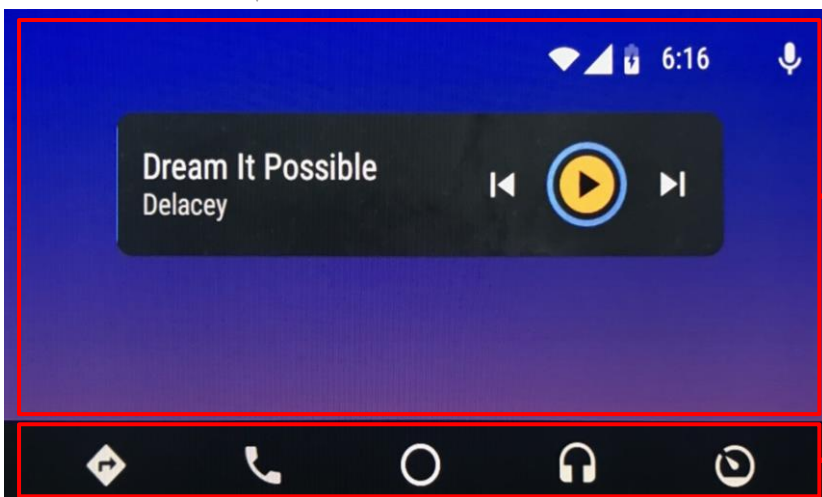

A area

B area

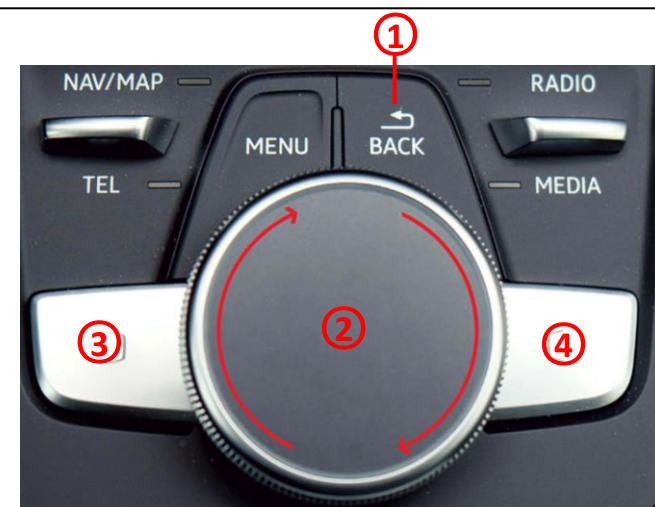

① : Return

② : Turn the dial to move menu-pointer; Click as confirm; Long press 3S to activate **Google Assistant**

③ : Menu-pointer switch to **A area**; Long press to bring up upper left menu

④ : Menu-pointer switch to **B area**



- Other settings

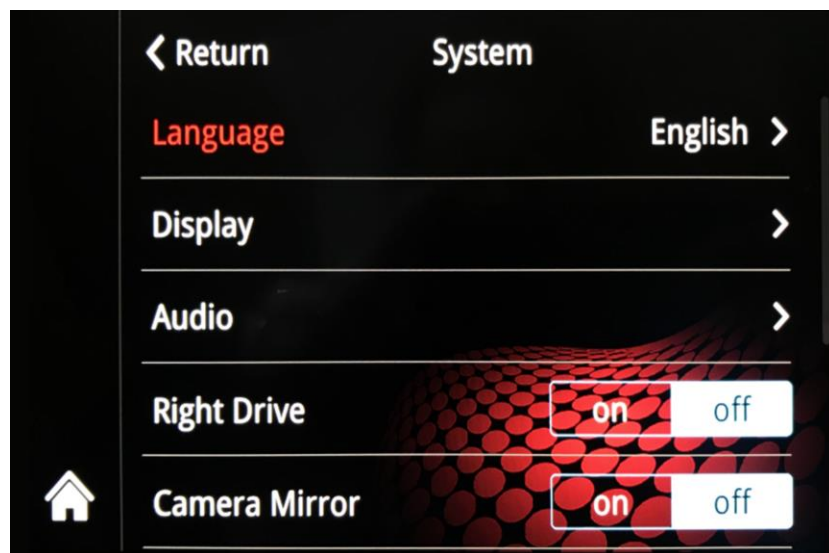

Display setting

Front image flip horizontal



Automatic front view display time, 0 means disable front view



Audio effect setting



Right/Left driving mode, also available for CarPlay

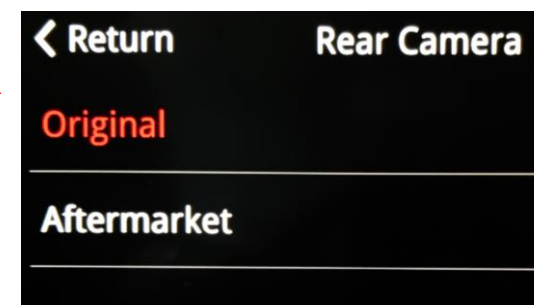

Choose reversing camera type







---

Copyright © Cartizan. All rights reserved.

